

## MONTAGE UND BEDIENUNGSANLEITUNG

### SN1480 / SN1490

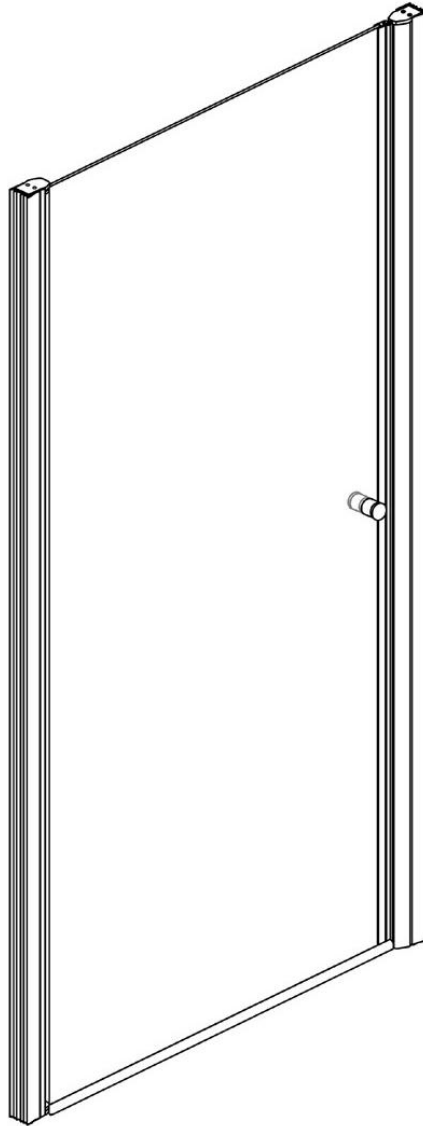

Size: 800x1950mm  
900x1950mm



**SANOTECHNIK**  
Handelsgesellschaft m.b.H.  
Industriestraße 5  
A-2752 Wöllersdorf  
Tel.: +43 2622 / 421 93 0  
Fax: +43 2622 / 421 93 6  
office@sanotechnik.at  
www.sanotechnik.com



**SANOTECHNIK Hungária Kft.**  
MAGYARORSZÁG  
Nagytétényi út 112  
H-1222 BUDAPEST  
Tel.: (+36 1) 424 06 70  
Fax: (+36 1) 424 06 79  
info@sanotechnik.hu  
www.sanotechnik.com



**SC Sanotechnik COM Rumänien S.R.L.**  
ROMANIA  
Tancabesti, DN 1, KM 26,5  
Com. Snagov, jud. Ilfov  
Tel.: +40 21 350 13 43  
Fax: +40 21 350 13 44  
office@sanotechnik.ro  
www.sanotechnik.com



**SANOTECHNIK d.o.o.**  
SLOVENIJA  
Stritarjevca ulica 24  
SI-2000 MARIBOR  
Tel. +3862/4213350  
Fax +3862/4213358  
info@sanotechnik.si  
www.sanotechnik.com



**SANOTECHNIK-MAUROD s.r.o.**  
SLOVAKIA & CZECHIA  
Sládkovičova 69  
SK-953 01 Zlaté Moravce  
Tel.: +421/376 426 245  
Fax: +421/376 426 246  
maurod@maurod.sk  
www.sanotechnik.com



**Sun Banyo**  
TURKEY  
Bostanci Mag. Bagdat  
Cd. Yonca apt. No. 504/5  
KADIKOY/ISTANBUL  
Tel: +90 216 384 6179  
Fax: +90 216 384 6180  
amasya@sanotechnik.com.tr



**Sanotechnik Bulgaria Ltd.**  
BULGARIA  
3, Georgi Benev St.  
BG-4003 Plovdiv  
Tel: +359 32 961101  
Fax: +359 32 961102  
office@sanotechnik.bg  
www.sanotechnik.com

## **General Information**

Please inspect the product immediately upon receipt for transit damage, missing packs/parts or manufacturing fault. Damage reported later cannot be accepted. Please handle the product with care avoiding knocks and shock loading to all sides and edges of the glass

### **Notes : Safety glass can not be re-worked.**

Please read these instructions carefully before start of installation.

Special care should be taken when drilling walls to avoid hidden pipes or electrical cables.

Note : this product is heavy and may require two people to install.

## **Aftercare instructions**

After use, your shower should be cleaned with soap and water. This is particularly important in hard water districts where insoluble lime salts may be deposited and allowed to build up.

Cleaners of gritty or abrasive nature should be used. Care should be taken to avoid contact with strong chemicals such as organic solvents and strippers.

Glass cleaners can be used but with caution, if in doubt contact the manufacturer of the cleaner in question.

Please keep these instructions for aftercare and customer service details.

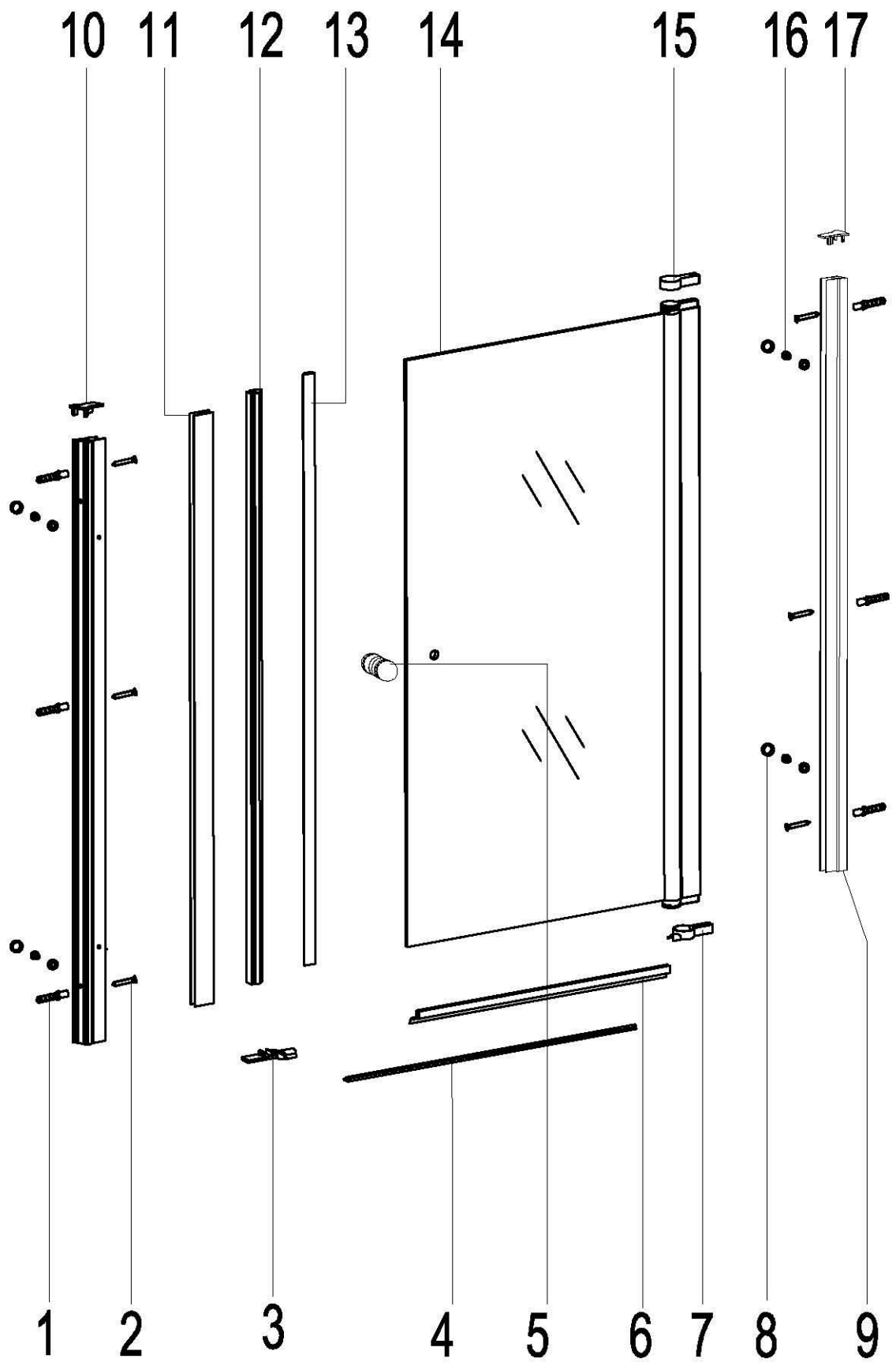

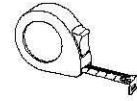
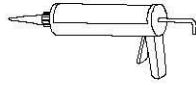
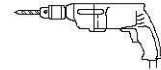
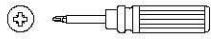
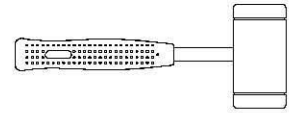
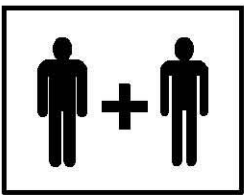

1

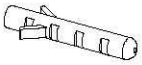

X6

2



ST3.9X35

X6

3



Left Right

X1

4

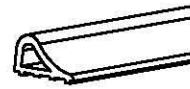

X1

5

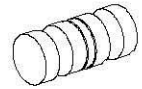

X1

6



X1

7



Left Right

X1

8

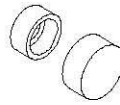

X4

9



X2

10



Left

X1

11

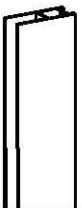

X6

12



X1

13

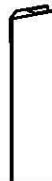

X1

14

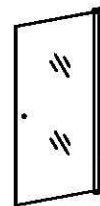

X1

15



X1

16



ST3.5X10

X4

17

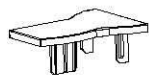

Right

X1

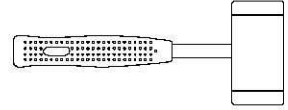
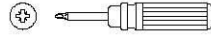
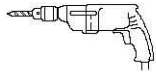
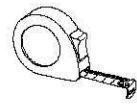
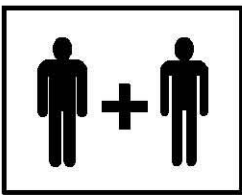

1



X6

2



ST3.9X35

X6

9

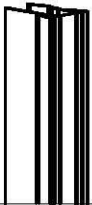

X2

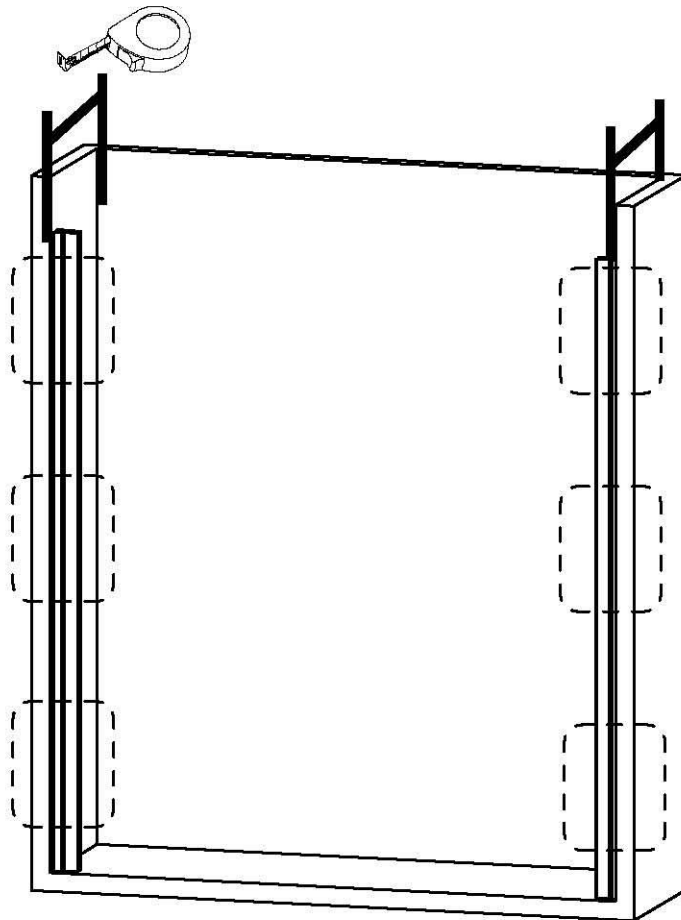

9

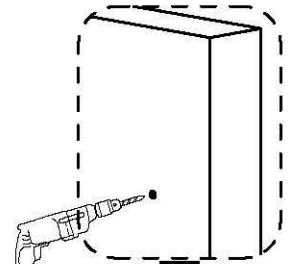
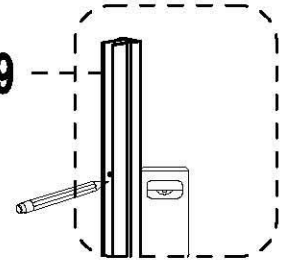

1

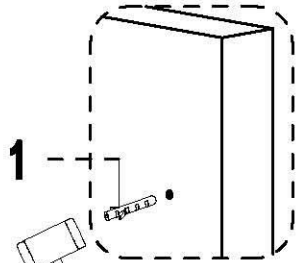

9

2

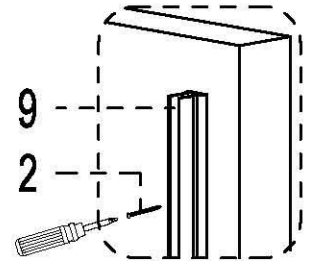

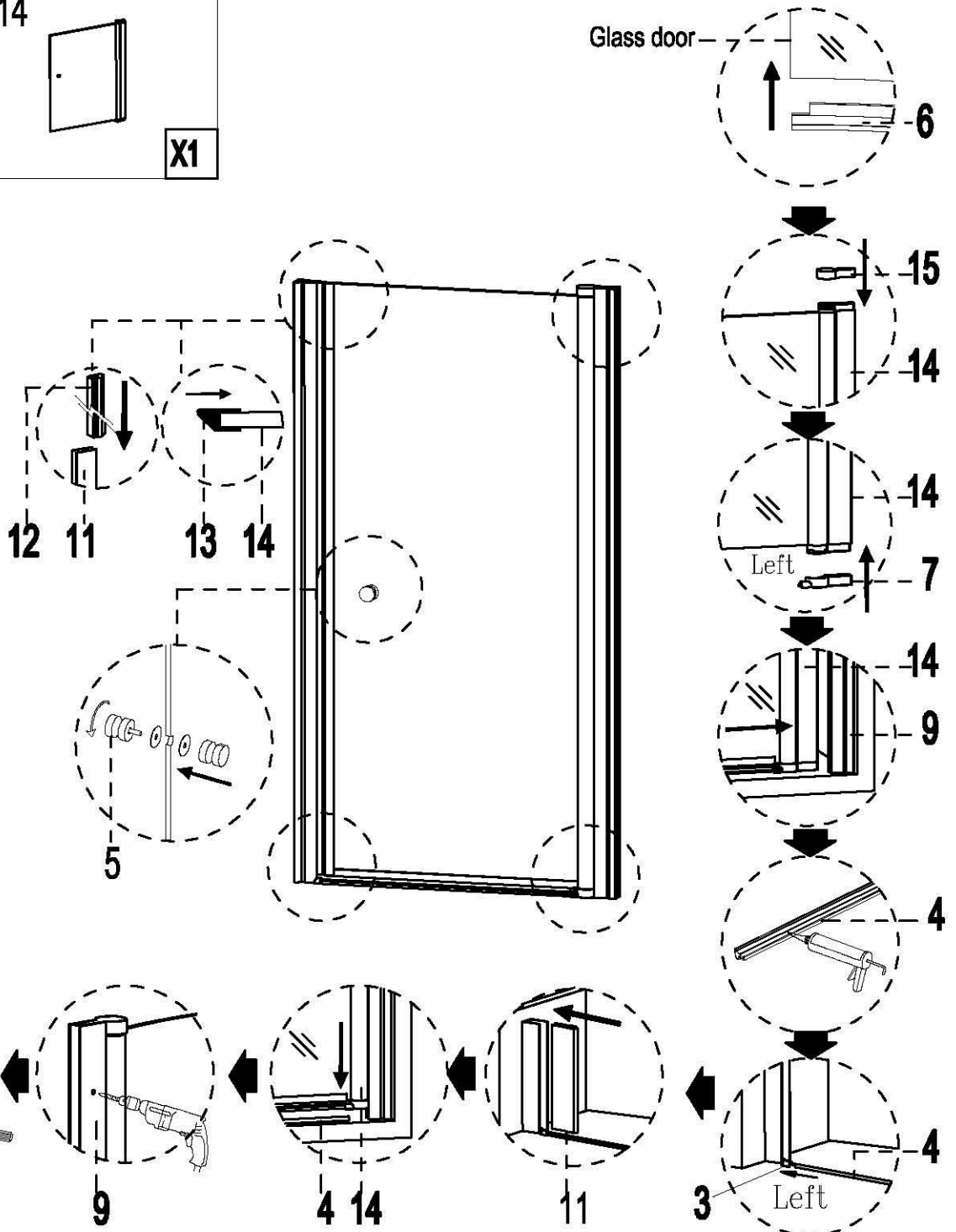
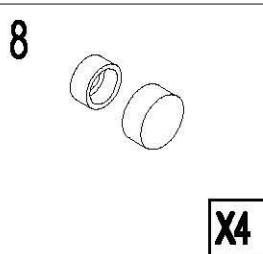
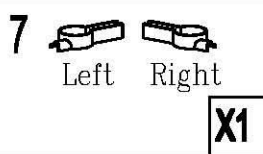
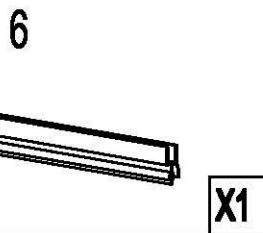
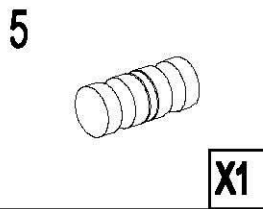
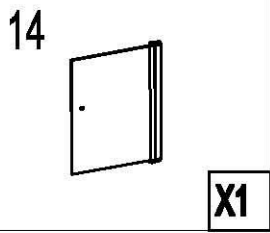
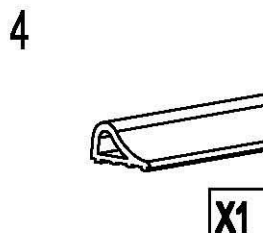
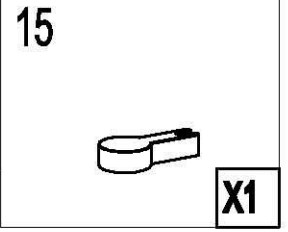
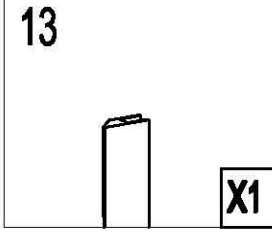
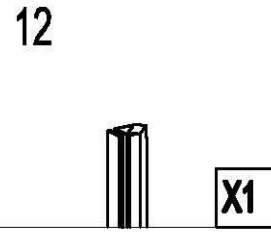
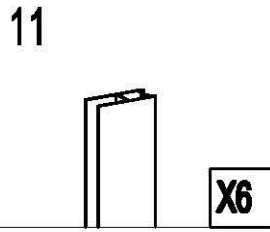
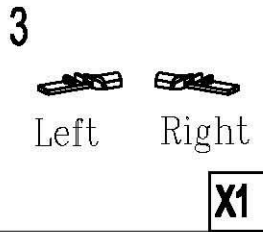
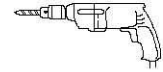
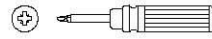
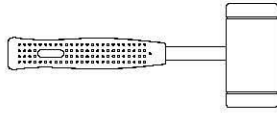
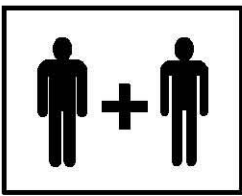

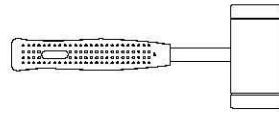
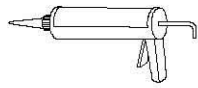
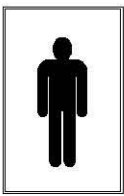

10



Left

X1

17

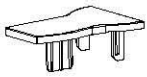

Right

X1

